

# SALIBA



## 33 The Comenarra Parkway Thornleigh NSW

3 1 2

Set on a generous parcel with a peaceful, leafy outlook, this well-presented home offers comfortable family living with multiple living zones and seamless indoor-outdoor flow. Designed for both relaxation and entertaining, it features a practical layout complemented by inviting outdoor spaces and ample parking.

**Type** : House  
**Price** : Auction, Contact Agent  
**Land Size** : 1042 sqm  
**View** : <https://www.saliba.com.au/33-the-comenarra-parkway-thornleigh-nsw-8662834/>

### Internal Features:

- Spacious open plan living and dining area that flows seamlessly to the outdoor verandah, perfect for relaxed everyday living and entertaining
- Well appointed kitchen with adjoining pantry, offering practicality and easy access to the main living zones
- Multiple living areas including a separate lounge and family room, providing flexibility for growing families

[For full version visit the website](#)



**Josh Saliba**  
(02) 4504 8004



**Tarik Goktas**  
(02) 4504 8004

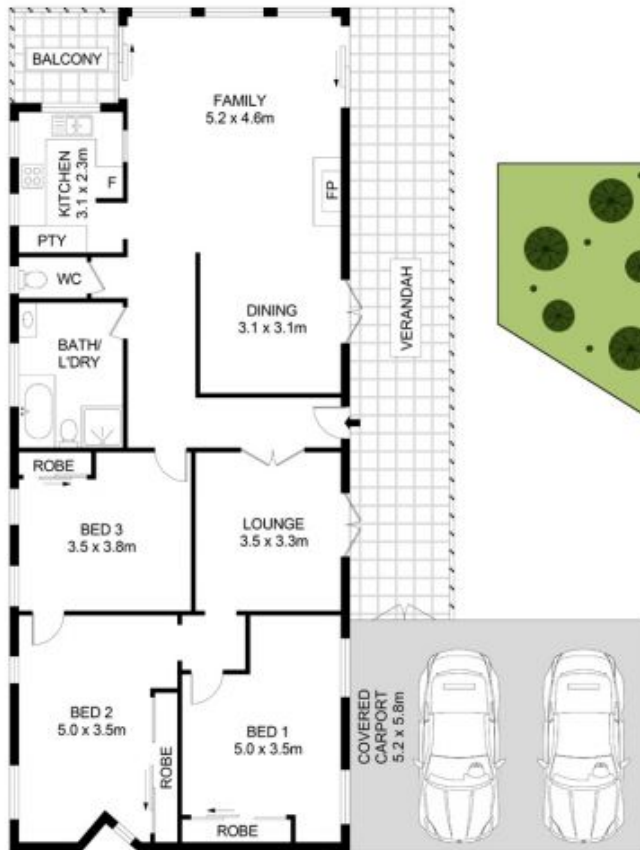

**SITE PLAN  
(NOT TO SCALE)**



### 33 The Comenarra Parkway, Thornleigh



Disclaimer- Floor Plan measurements are approximate and are for illustrative purposes only. While we cannot doubt the floor plans accuracy, we make no guarantee, warranty or representation as to the accuracy and completeness of the floor plan

**INTERNAL AREA :- 159 SQM**