

SALIBA



5 Poinciana Close Mount Colah NSW

4  2  2 

This charming family home offers a versatile layout with multiple living spaces, a modern kitchen, and a private master retreat. Outdoors, enjoy the expansive covered deck, lush gardens, and ample parking options, all set in a peaceful cul-de-sac location.

Type : House
Land Size : 750 sqm
View : <https://www.saliba.com.au/5-poinciana-close-mount-colah-nsw-8454687/>

Internal Features:

- Multiple spacious living areas offering comfort and versatility for the whole family
- Modern kitchen seamlessly connected to dining and meals spaces for easy entertaining
- Private master bedroom featuring a walk-in robe and stylish ensuite
- Additional well-sized bedrooms complete with built-in wardrobes



Anthony Chau
(02) 4504 8004



Marcus Bentivoglio
(02) 4504 8004

[For full version visit the website](https://www.saliba.com.au)

<https://www.saliba.com.au>

SALIBA

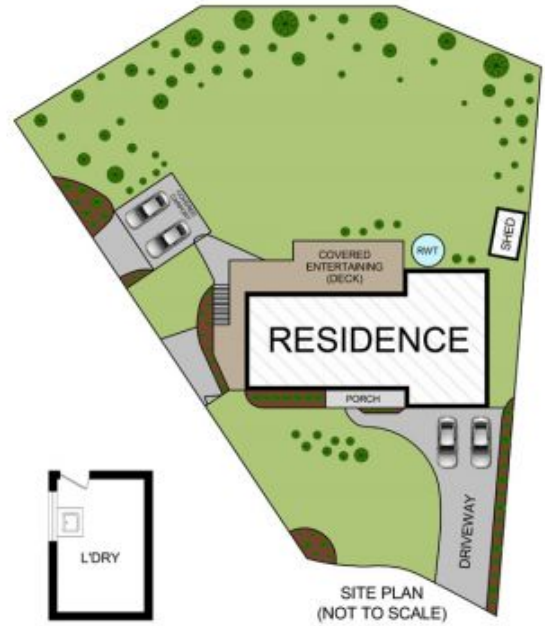
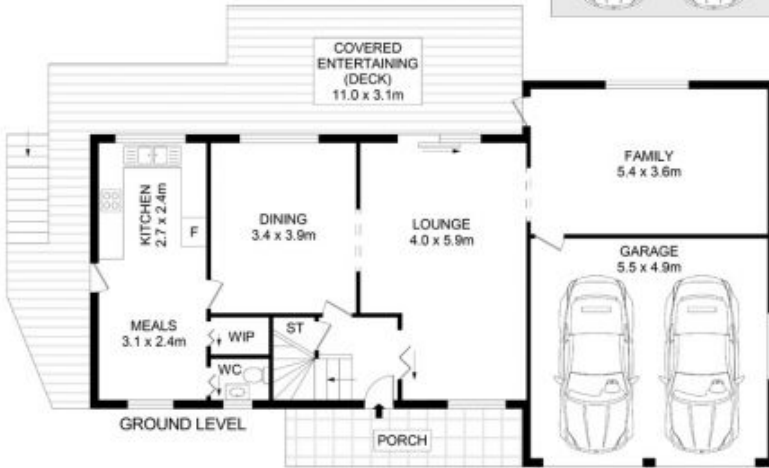
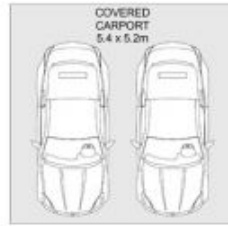

5 Poinciana Close, Mount Colah



Disclaimer- Floor Plan measurements are approximate and are for illustrative purposes only. While we cannot doubt the floor plans accuracy, we make no guarantee, warranty or representation as to the accuracy and completeness of the floor plan

TOTAL AREA : 194 SQM