

SALIBA



26 Silver Ash Way Thornleigh NSW

3 2 2

This stylish residence offers a seamless blend of modern comfort and practical design, with spacious open-plan living flowing to a sunlit terrace and landscaped outdoor entertaining area. Featuring a contemporary kitchen, generous bedrooms, and a secure double garage, it provides a low-maintenance lifestyle in a peaceful setting.

Type : Townhouse
Price : \$ 1,525,000
Land Size : 278 sqm
View : <https://www.saliba.com.au/26-silver-ash-way-thornleigh-nsw-8275158/>

Internal Features:

- Spacious open-plan living and dining area seamlessly extending to a sunlit terrace
- Contemporary kitchen with sleek finishes, ample storage, and a convenient pantry
- Thoughtfully designed layout with voids enhancing natural light and airflow
- Three well-proportioned bedrooms, including a master

[For full version visit the website](https://www.saliba.com.au)



Josh Saliba
(02) 4504 8004



David Kim
(02) 4504 8004

SALIBA

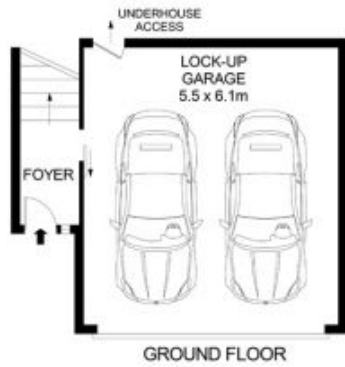
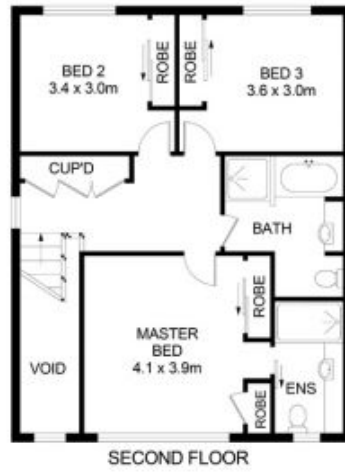

SITE PLAN (NOT TO SCALE)



26 Silver Ash Way, Thornleigh

Disclaimer- Floor Plan measurements are approximate and are for illustrative purposes only. While we cannot doubt the floor plans accuracy, we make no guarantee, warranty or representation as to the accuracy and completeness of the floor plan

TOTAL AREA 157 SQM