

SALIBA



8/2A Rupert Street Mount Colah NSW

3  **2**  **2** 

This modern, stylish open plan three-bedroom townhouse offers luxurious living with a contemporary kitchen, and a private enclosed courtyard situated on 213sqm.

Located in a family-friendly neighborhood, it provides easy access to local amenities, schools, and public transport.

Internal Features

- Spacious living and dining area, perfect for entertaining family & guests
- Modern high quality U-shaped kitchen featuring 40mm stone countertops, gas cooking, sleek cabinetry, quality appliances, and ample countertop space for meal preparation
- Large pantry/storage or study nook

[For full version visit the website](https://www.saliba.com.au)

Type : Townhouse
Price : \$ 1,150,000
Building Size : 213 sqm
View : <https://www.saliba.com.au/82a-rupert-street-mount-colah-nsw-8083402/>



Iain Rosekilly
(02) 4504 8004



Anthony Chau
(02) 4504 8004

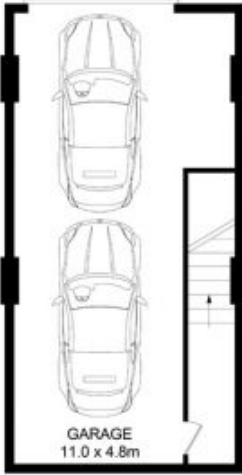
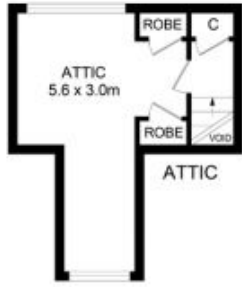

BASEMENT

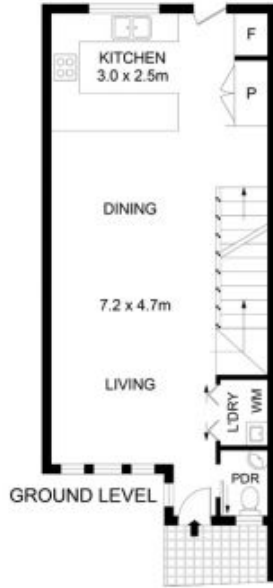

SITE PLAN
(NOT TO SCALE)

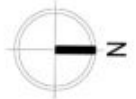

8/2A Rupert Street, Mount Colah



Disclaimer- Floor Plan measurements are approximate and are for illustrative purposes only. While we cannot doubt the floor plans accuracy, we make no guarantee, warranty or representation as to the accuracy and completeness of the floor plan

INTERNAL AREA	:	112 SQM
EXTERNAL AREA	:	5 SQM
TOTAL AREA	:	117 SQM