

# SALIBA



11/2 Bundarra Avenue Wahroonga NSW

2  2  1 

APPLY NOW BY SCANNING OUR QR CODE IN THE PHOTO GALLERY OR COPY AND PASTE THIS LINK INTO YOUR BROWSER: <https://t-app.com.au/app/page-1/>

This Apartment has an ideal location, making commutes extremely convenient. Amenities are just a stone throw away, with local shops, train station, Hospital and local schools close by. Positioned within a well maintained complex, this oversized two bedroom property certainly has everything right at your fingertips.

- Spacious combined lounge and dining
- Open plan living
- Dining area flows through to a large tiled balcony
- Well appointed gas kitchen with stone bench top and

[For full version visit the website](#)

**Type** : Unit  
**Building Size** : 91 sqm  
**Land Size** : 3018 sqm  
**View** : <https://www.saliba.com.au/112-bundarra-avenue-wahroonga-nsw-7805137/>



**Lucy Hewitt**  
**(02) 4504 8004**

<https://www.saliba.com.au>

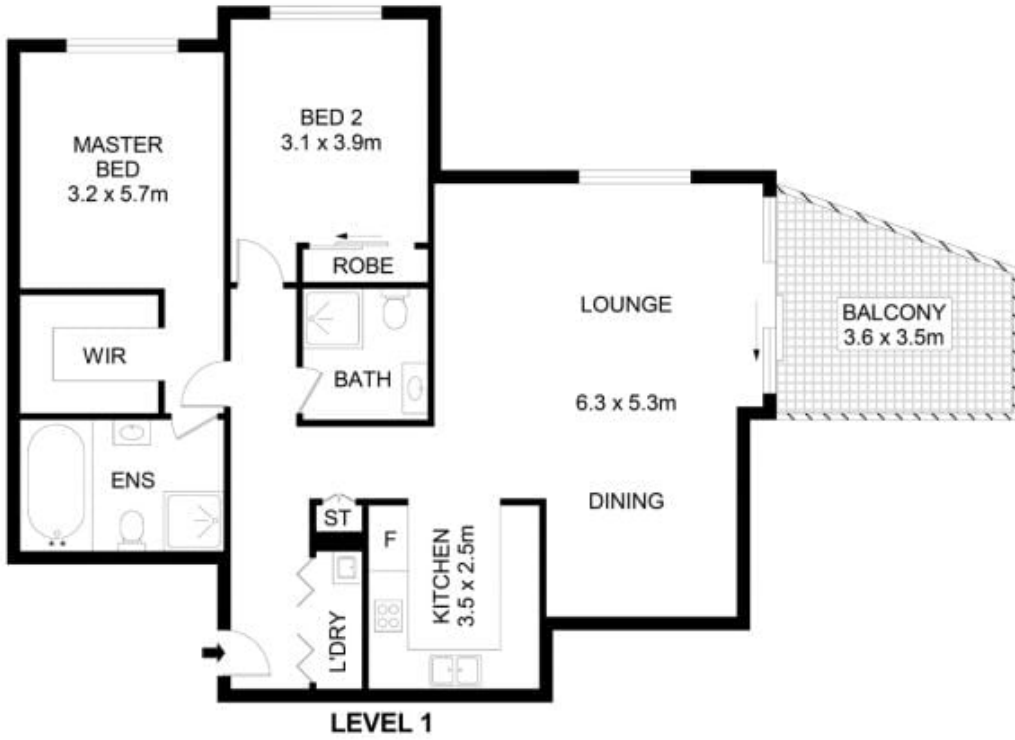

**BASEMENT 2**

11/2 Bundarra Ave, Wahroonga



Disclaimer- Floor Plan measurements are approximate and are for illustrative purposes only. While we cannot doubt the floor plans accuracy, we make no guarantee, warranty or representation as to the accuracy and completeness of the floor plan

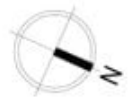

INTERNAL AREA	89 SQM
EXTERNAL AREA	13 SQM
TOTAL AREA	102 SQM