

SALIBA



14 Butterfield Street Thornleigh NSW

4  2  2 

Nestled in the serene suburb of Thornleigh, this remarkable family home offers a harmonious blend of tranquility and convenience. Surrounded by lush greenery and boasting a great location, this property provides a peaceful retreat for a growing family. With its spacious interior, high ceilings, and polished wood flooring, the home exudes a sense of elegance and style. Step inside and discover a generously-sized living and dining area, a large, neatly kept kitchen, and an additional family room, perfect for modern living. Other features include:

- North-east facing back yard for abundant natural light
- Tranquil setting amidst lush greenery
- Master bedroom with ensuite and built-in robe
- Two additional bedrooms, one with a built-in robe

[For full version visit the website](https://www.saliba.com.au/14-butterfield-street-thornleigh-nsw-7608995/)

Type : House
Price : \$ 1,775,000
Land Size : 746 sqm
View : <https://www.saliba.com.au/14-butterfield-street-thornleigh-nsw-7608995/>



Josh Saliba
(02) 4504 8004

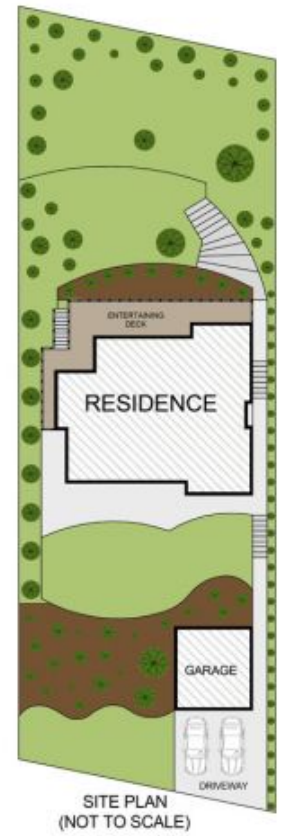

14 Butterfield St, Thornleigh

Disclaimer- Floor Plan measurements are approximate and are for illustrative purposes only. While we cannot doubt the floor plans accuracy, we make no guarantee, warranty or representation as to the accuracy and completeness of the floor plan



INTERNAL AREA - 196 SQM