

# SALIBA



4/140-148 Crimea Road Marsfield NSW

2  2  1 

This charming home is situated in an ideal location, offering both convenience and comfort. As you step inside, you'll immediately be impressed by the spacious and open living area, perfect for relaxing or entertaining guests.

Well - presented kitchen has lots to offer such as stone tops and ample storage space, making cooking a breeze. Upstairs, you'll find two cozy bedrooms that provide plenty of space for a good night's sleep. The master bedroom boasts ample natural light, creating a warm and inviting atmosphere.

The townhouse also features a beautifully low maintenance backyard, providing the perfect spot for enjoying the outdoors. With its convenient location, you'll have easy

**Type** : Townhouse

**Price** : \$ 835,000

**View** : <https://www.saliba.com.au/4140148-crimea-road-marsfield-nsw-7466440/>



**Iain Rosekilly**  
(02) 4504 8004

[For full version visit the website](https://www.saliba.com.au)

<https://www.saliba.com.au>

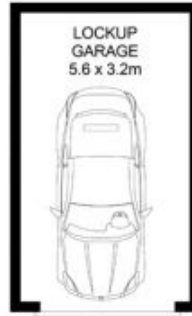
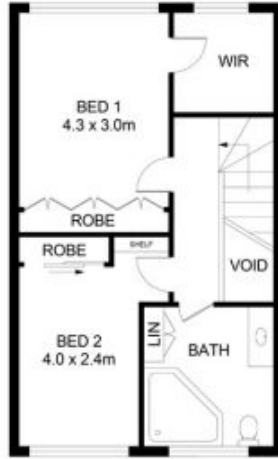
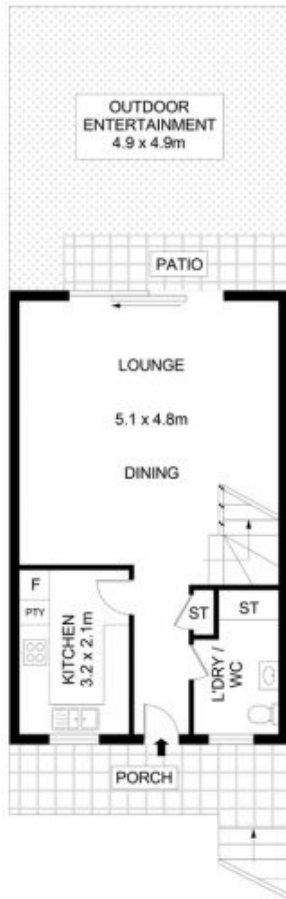

4/140-148 Crimea Rd, Marsfield



Disclaimer- Floor Plan measurements are approximate and are for illustrative purposes only. While we cannot doubt the floor plans accuracy, we make no guarantee, warranty or representation as to the accuracy and completeness of the floor plan

SITE PLAN (NOT TO SCALE)

INTERNAL AREA · 129 SQM