

SALIBA



34/2A Yardley Avenue Waitara NSW

2  1  1 

Set in a whisper quiet street within a highly convenient location in the heart of Waitara is the perfect opportunity for a first home buyer or investor. Immaculately presented this home offers an open plan spacious light filled layout with a combined lounge and dining room, neatly presented kitchen and balcony.

Type : Unit
Price : \$ 655,000
Building Size : 87 sqm
View : <https://www.saliba.com.au/342a-yardley-avenue-waitara-nsw-7408094/>

Set in a prime location this unit is an easy approx. 4 minute walk to Waitara train station and approx. 15 minute walk to Westfield Hornsby Shopping Centre. It also offers a single car space and an outdoor common area with pool facilities and manicured gardens.

- Open plan living/dining area
- Spacious kitchen with electric cook top

[For full version visit the website](https://www.saliba.com.au)

<https://www.saliba.com.au>

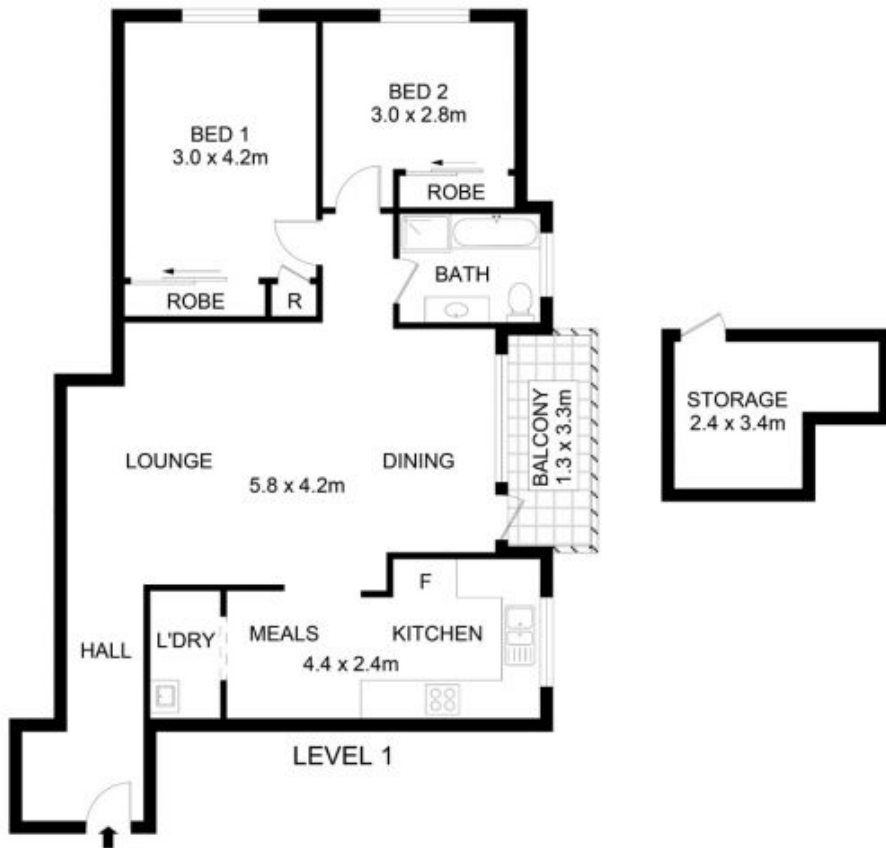

34/2A Yardley Ave, Waitara

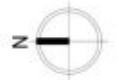

Disclaimer- Floor Plan measurements are approximate and are for illustrative purposes only. While we cannot doubt the floor plans accuracy, we make no guarantee, warranty or representation as to the accuracy and completeness of the floor plan

INTERNAL AREA - 87 SQM